

Garlock PSLUR Seal Premium Slurry Seal

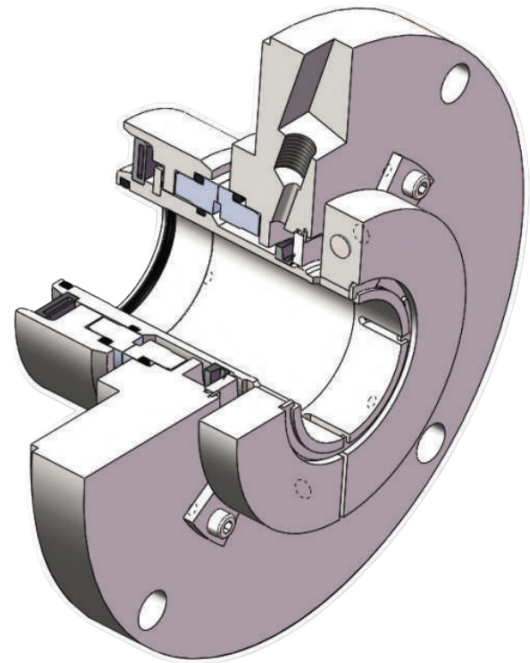

Features and Benefits

- Robust construction handles slurry concentration up to 60% solids by weight
- Abrasion resistant metal components and interchangeable silicon carbide faces extend service for max seal life
- Open design allows seal to operate w/o flush water to help reduce product dilution
- Encapsulated cone spring increases reliability by providing even spring load to seal faces w/o wearing or clogging
- All static secondary seals which means no hang up
- Easy and accurate installation is realized by the cartridge design from the pump's dry or wet end with no special tools
- Six group sizes cover most of the slurry pump equipment giving maximum flexibility with reduced inventory
- Optional Plan 62 grease or water quench with outboard lip seal provides seal face lubrication for dry running cycles



Standard Materials:

- **Primary Ring:** Silicon Carbide, Tungsten Carbide
- **Mating Ring:** Silicon Carbide, Tungsten Carbide
- **Cone Spring:** Viton
- **Elastomers:** Viton, Aflas
- **Gland Plate & Sleeve:** Duplex Stainless Steel, Alloy 276, 316SS
- **All other Hardware:** 304SS/316SS

Operating Conditions:

- **Pressures:** up to 300 psig/21 bar
- **Temperature:** up to 170°F/77°C w/o quench up to 248°F/120°C with quench
- **Speed:** up to 3600 rpm, 3000 fpm/15 m/s

Seals pressure tested before shipment

Helping Industry Become; More Safe, More Productive, More Sustainable

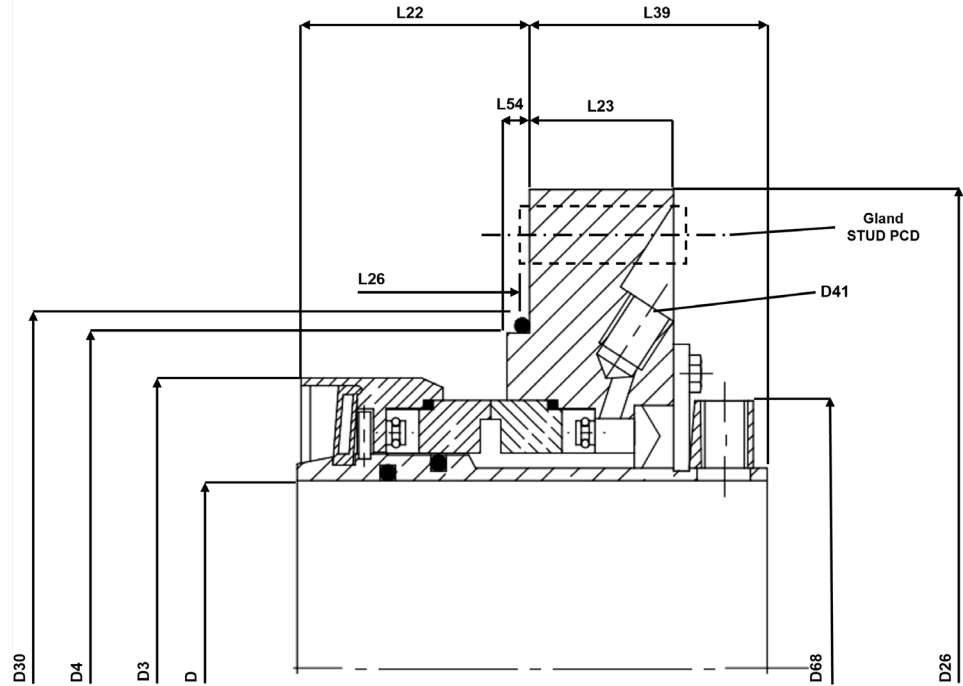

Group	D	D3	D4	D26	D30	D41	D68	L22	L23	L26	L39	Gland Stud PCD
1	1.375 – 2.000	3.898	n/a	4.961	5.236	1/4" NPT	2.48	1.654	0.957	n/a	1.457	n/a
2	2.000 – 3.25	5.354	6.419	8.543	6.799	1/4" NPT	4.449	2.146	0.984	0.11	1.772	7.677
3	3.250 – 4.125	6.693	7.285	9.567	7.898	1/4" NPT	6.063	2.736	0.827	0.171	2.323	8.661
4	4.125 – 5.31	8.032	8.269	11.339	8.882	3/8" NPT	7.717	2.736	1.063	0.171	2.638	10.236
5	5.313 – 7.063	10.157	10.632	13.78	11.25	3/8" NPT	9.252	3.406	0.984	0.217	2.638	12.598
6	7.063 – 8.625	12.205	12.885	16.85	13.507	3/8" NPT	11.417	3.976	1.181	0.206	2.835	15.276

Group	D	D3	D4	D26	D30	D41	D68	L22	L23	L26	L39	Gland Stud PCD
1	35 - 51	99	n/a	140	133	1/4" NPT	63	42	24.3	n/a	37	n/a
2	51 - 82.5	136	163	217	172.7	1/4" NPT	113	54.5	25	2.81	45	195
3	82.5 - 105	170	185	243	200.6	1/4" NPT	154	69.5	21	4.33	59	220
4	105 - 135	204	210	288	225.6	3/8" NPT	196	69.5	27	4.33	67	260
5	135 - 180	258	270	350	285.8	3/8" NPT	235	86.5	25	5.52	67	320
6	180 - 220	310	327.3	428	343.1	3/8" NPT	290	101	30	5.23	72	388

Popular Slurry Pumps

Size	Model
50mm	1.5/1B-AH/1 Stage
60mm	3/2 C-AH/1 stage
60mm	4/3 C-AH
75mm	150 PE-PC/HOR/1 stage

Size	Model
85mm	4/3D-AH
85mm	6/4 D-AH
95mm	200PF-PC
95mm	150PF-PCH/HOR/1 stage

Size	Model
100mm	6/4E-AH
100mm	8/6E-AH
110mm	200 WBH
135mm	250PG-PC HOR/1 stage

Helping Industry Become; More Safe, More Productive, More Sustainable